



AMP ★ AMPLIVERSAL ★ CRIMPING  
TOOL NO. 825508-5

<b>IS 2746</b>	
RELEASED	10-10-80
REVISED	

**1. INTRODUCTION**

This tool, shown in Figure 1, is used to crimp:

- PIDG ★ terminals and butt splices on stranded copper wire sizes 22 thru 10 AWG.
- PLASTI-GRIP ★ terminals and butt splices on solid or stranded copper wire sizes 22 thru 10 AWG.

**2. CUT WIRE**

Insert wire in cutter, close handles briskly.

**3. GAGE WIRE**

Determine wire size by inserting unstripped wire into the smallest color coded gage ring that will accept the wire. See Figure 2. After stripping, use the adjacent crimp closure to crimp terminal or splice on wire.

**4. STRIP WIRE**

Partially open handles and insert wire in correct notch of wire stripping blades. End of wire must butt against strip length locator (controls strip length). See Figure 3. Close handles fully and rotate tool part way around the wire. Pull wire from tool.

*NOTE: Be sure there are no cut or missing conductor strands.*

**5. COLOR CODE**

Select the correct color coded terminal or splice for the wire size being used.

- Red = AWG 22-16 (0.25—1.5mm<sup>2</sup>)
- Blue = AWG 16-14 (1.5—2.5mm<sup>2</sup>)
- Yellow = AWG 12-10 (4—6mm<sup>2</sup>)

**6. CRIMP TERMINAL OR SPLICE**

- Insert color coded terminal or splice in crimp closure adjacent to the matching color coded wire gage ring.
- Position terminal or splice in crimp closure as shown in Figure 4 or 5.
- Partially close handles to hold terminal or splice firmly in die closure.
- Insert stripped wire into terminal until end of conductor is at least flush with or extended slightly beyond end of terminal wire barrel.

Insert stripped wire into splice until end of conductor butts against splice wire stop.

*NOTE: Do not use wires with nicked or missing conductor strands.*

- Close handles fully, then open handles by depressing release lever.
- To crimp other half of splice, remove it and reposition uncrimped half in tool as shown in Figure 5. Follow same procedure used to crimp first half of splice. If splice cannot be turned, turn tool around.
- Refer to Figure 6 for terminal or splice crimp inspection procedure.

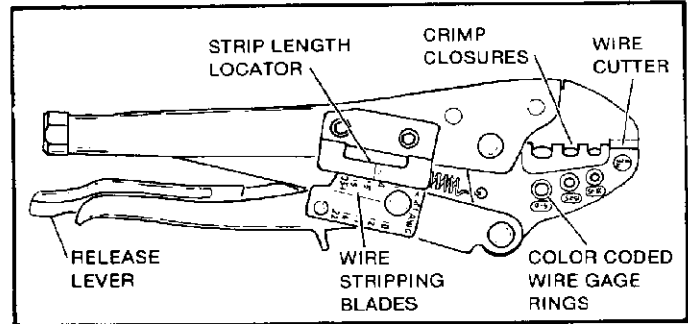

Figure 1

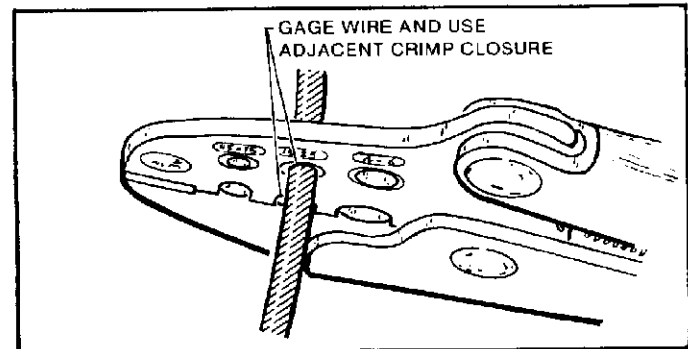

Figure 2

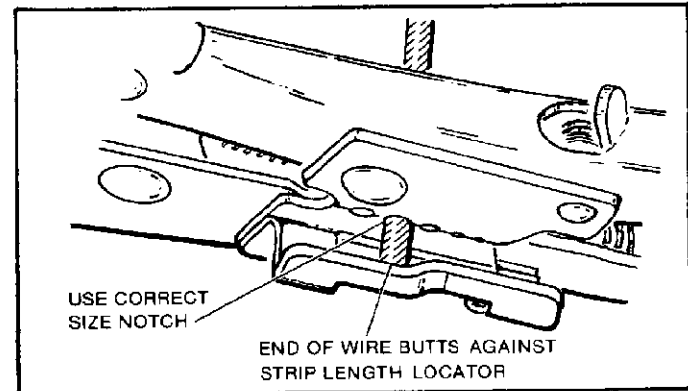

Figure 3

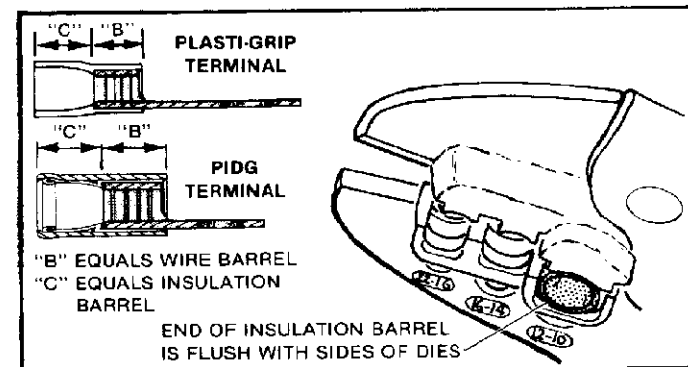

Figure 4

Copyright 1980 by AMP Incorporated, Harrisburg, Pa. All International Rights Reserved. AMP Incorporated products covered by U.S. and Foreign Patents and/or Patents Pending.

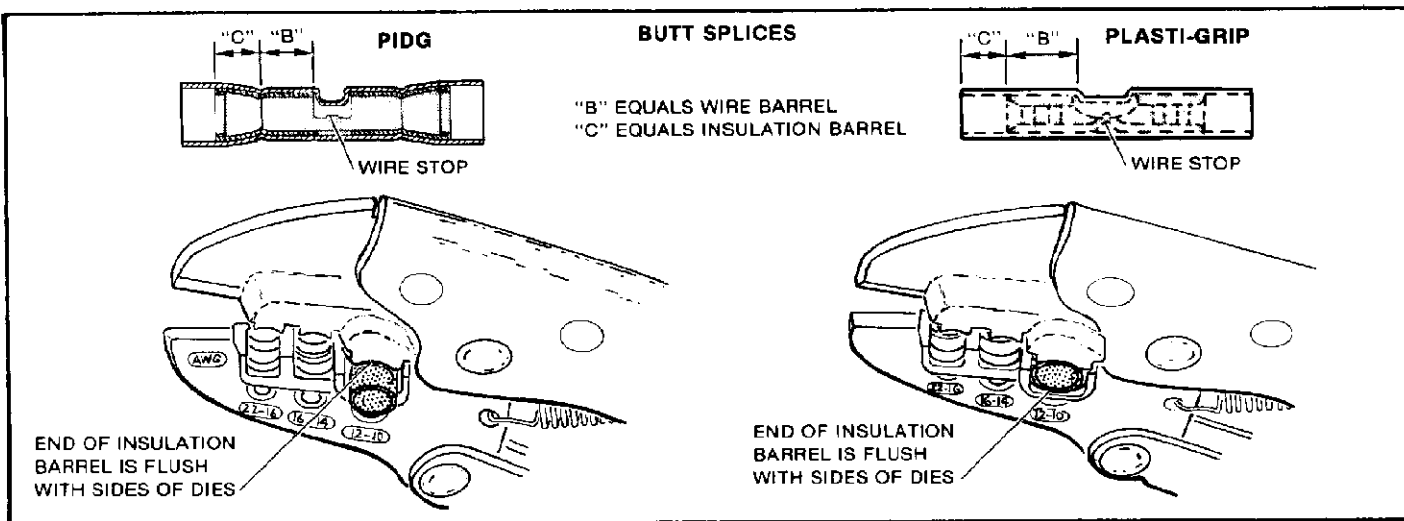

Figure 5

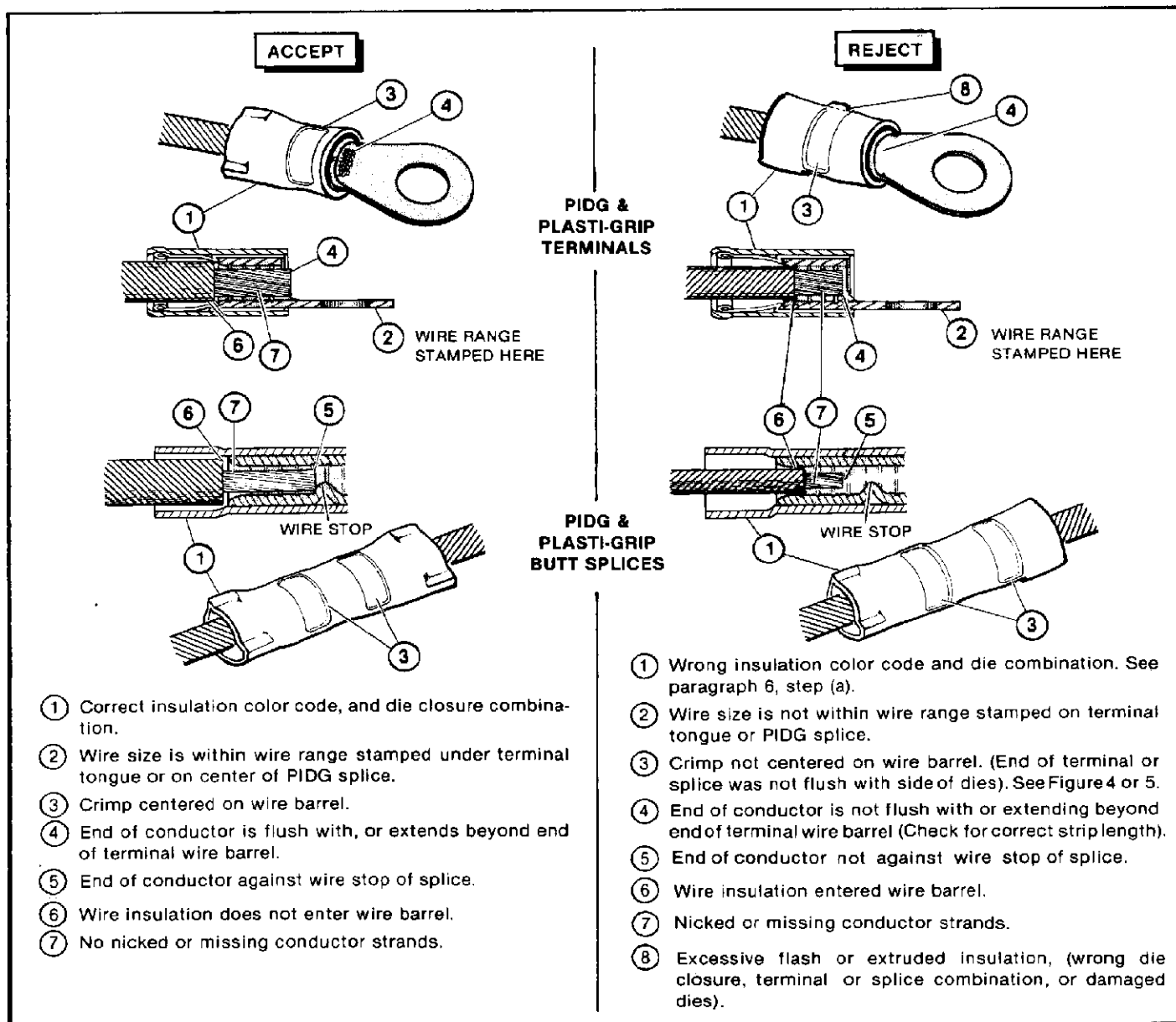

Figure 6